



# Meeting Rooms & Event Space at CoWorks

We're in the business of creating connections. Our open-concept, customize-able space is designed to host, facilitate and elevate a wide range of events from corporate parties to business and social gatherings up to 75 people.



**CoWorks**  
BY ELEVATE

[cwlangley@coworksbyelevate.com](mailto:cwlangley@coworksbyelevate.com)  
[www.coworksbyelevate.com](http://www.coworksbyelevate.com)  
**604-546-1540**

# GROWTH MEETING ROOM

Located on the second floor, the Growth meeting room is ideal for smaller gatherings and includes:

- ✓ 43" wall mounted monitor with HDMI hook up
- ✓ 24" x 36" white board
- ✓ Telephone for conference calling
- ✓ Access to main floor self-serve kitchen stocked with coffee, tea and water is included
- ✓ Outside food is permitted

## Business Hours\*:

Monday to Friday 9:00 AM - 5:00 PM	\$25 per hour
Half Day - 4 Hours Available 9:00 AM to 1:00 PM or 1:00 PM to 5:00 PM	\$95
Full Day - 8 Hours	\$185

\*Minimum 30 minutes

## Outside Business Hours\*:

Weekdays before 9:00 AM and after 5:00 PM and Weekends	\$45 per hour
Half Day - 4 Hours	\$170
Full Day - 8 Hours	\$330

\*Minimum 2 hours

**Boardroom Style**  
6-person capacity

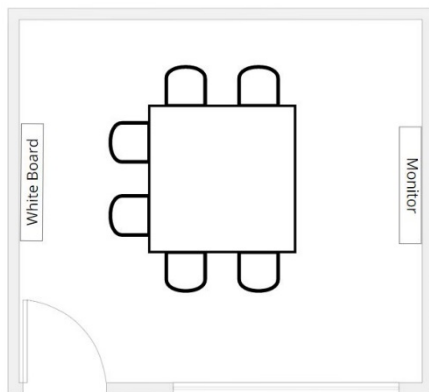

**Circle Style**  
8-person capacity

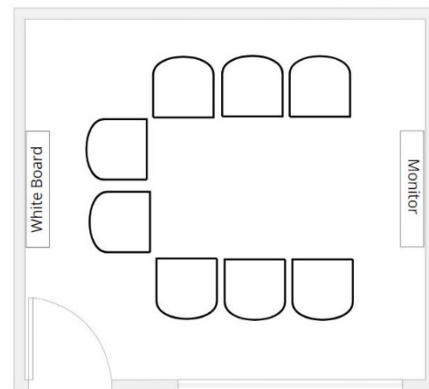

# INNOVATION MEETING ROOM

Located on the first floor, the Innovation meeting room is ideal for groups up to 10 people and includes:

- ✓ 55" wall mounted monitor with HDMI hook up
- ✓ 24" x 36" white board
- ✓ Telephone for conference calling
- ✓ Access to main floor self-serve kitchen stocked with coffee, tea and water is included
- ✓ Outside food is permitted

## Business Hours\*:

Monday to Friday 9:00 AM - 5:00 PM	\$35 per hour
Half Day - 4 Hours Available 9:00 AM to 1:00 PM or 1:00 PM to 5:00 PM	\$130
Full Day - 8 Hours	\$255

\*Minimum 30 minutes

## Outside Business Hours\*:

Weekdays before 9:00 AM and after 5:00 PM and Weekends	\$55 per hour
Half Day - 4 Hours	\$205
Full Day - 8 Hours	\$400

\*Minimum 2 hours

**Boardroom Style**  
8-person capacity

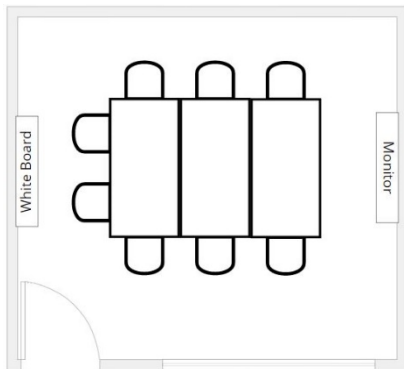

**Circle Style**  
10-person capacity

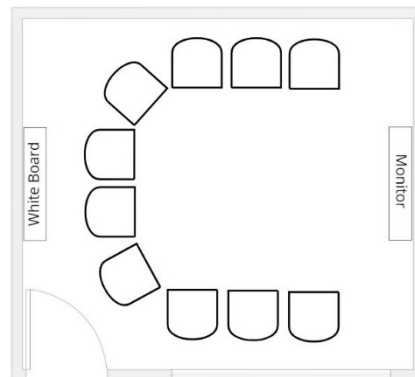

# CONNECTION MEETING ROOM

Located on the first floor, the Connection meeting room is ideal for groups up to 35 people and includes:

- ✓ 55" portable monitor with HDMI hook up
- ✓ 48" x 60" portable white board
- ✓ Telephone for conference calling
- ✓ Access to the self-serve kitchen stocked with coffee, tea and water is available at an additional fee of \$3 per person
- ✓ Outside food is permitted at an additional fee. Catering options organized by the venue are also available.

## Business Hours\*:

Monday to Friday 9:00 AM – 5:00 PM	\$55 per hour
Half Day – 4 Hours Available 9:00 AM to 1:00 PM or 1:00 PM to 5:00 PM	\$205
Full Day – 8 Hours	\$400

\*Minimum 30 minutes

## Outside Business Hours:

Weekdays before 9:00 AM and after 5:00 PM and Weekends	\$75 per hour
Half Day – 4 Hours	\$280
Full Day – 8 Hours	\$550

\*Minimum 1 hours

**Boardroom Style**  
16-person capacity

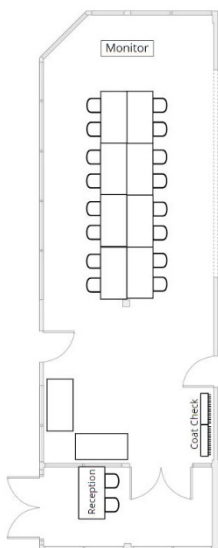

**Banquet Style**  
32-person capacity

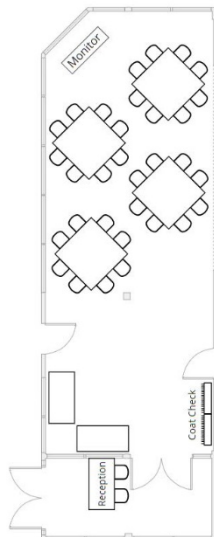

**Classroom Style**  
22-person capacity

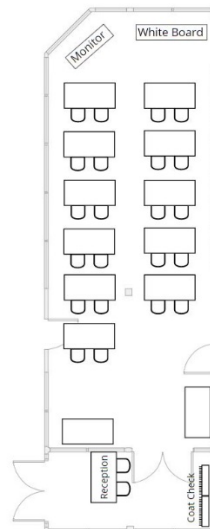

**Theatre Style**  
35-person capacity

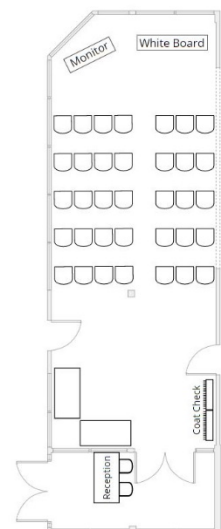

# THE MAIN EVENT ROOM

Located on the first floor, The Main Event room is ideal for groups up to 64 people and includes:

- ✓ 64 chairs
- ✓ 16 rectangle tables (30" x 60") for multiple configurations
- ✓ Additional lounge furniture
- ✓ Portable granite bar top (67"L x 46"W x 37"H)
- ✓ 55" portable monitor with HDMI hook up
- ✓ In-house sound system with wireless microphone
- ✓ Private event entrance
- ✓ Access to the self-serve kitchen stocked with coffee, tea and water is available at an additional fee of \$3 per person
- ✓ Outside food is permitted at an additional fee. Catering options organized by the venue are also available

## Business Hours:

Monday to Friday 9:00 AM – 5:00 PM	\$135 per hour
Half Day – 4 Hours Available 9:00 AM to 1:00 PM or 1:00 PM to 5:00 PM	\$515
Full Day – 8 Hours	\$1000

## Outside Business Hours:

Weekdays before 9:00 AM and after 5:00 PM and Weekends	\$155 per hour
Half Day – 4 Hours	\$590
Full Day – 8 Hours	\$1150

**Banquet Style**  
64-person capacity

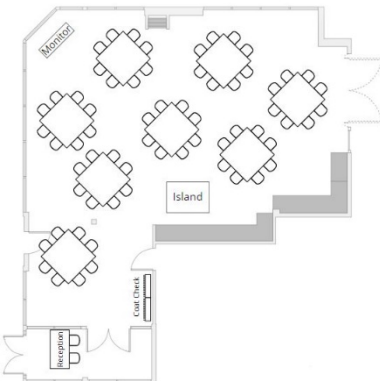

**Classroom Style**  
28-person capacity

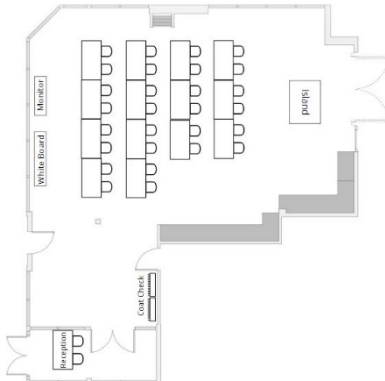

**Theatre Style**  
60-person capacity

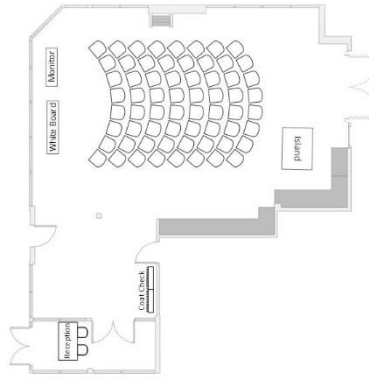

**Conference Style**  
26-person capacity

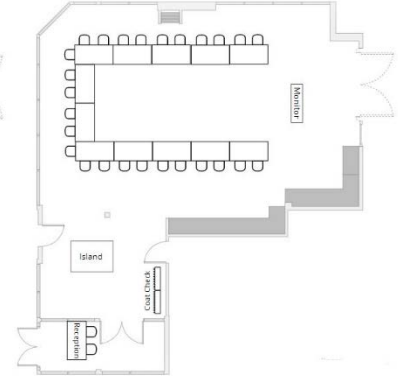

## THE MAIN EVENT ROOM AND LOUNGE

Located on the first floor, The Main Event Room and Lounge is ideal for groups up to 75 people and includes:

- ✓ 64 chairs
- ✓ 16 rectangle tables (30" x 60") for multiple configurations
- ✓ Additional lounge furniture
- ✓ Portable granite bar top (67"L x 46"W x 37"H)
- ✓ 55" portable monitor with HDMI hook up
- ✓ In-house sound system with wireless microphone
- ✓ Private event entrance
- ✓ Access to the self-serve kitchen stocked with coffee, tea and water is available at an additional fee of \$3 per person
- ✓ Outside food is permitted at an additional fee. Catering options organized by the venue are also available

### Business Hours:

Monday to Friday 9:00 AM - 5:00 PM	\$180 per hour
Half Day - 4 Hours Available 9:00 M to 1:00 PM or 1:00 PM to 5:00 PM	\$675
Full Day - 8 Hours	\$1325

### Outside Business Hours:

Weekdays before 9:00 AM and after 5:00 PM and Weekends	\$200 per hour
Half Day - 4 Hours	\$750
Full Day - 8 Hours	\$1475

**Banquet Style**  
64-person capacity

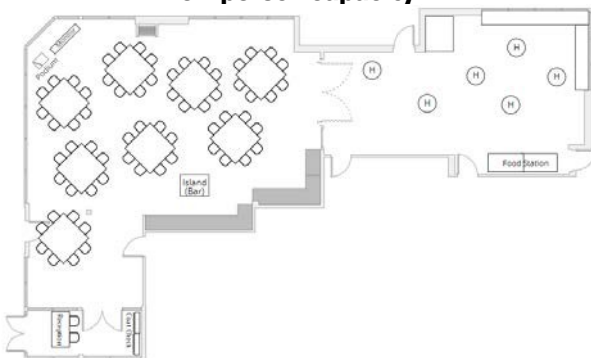

**Cocktail Style**  
75-person capacity

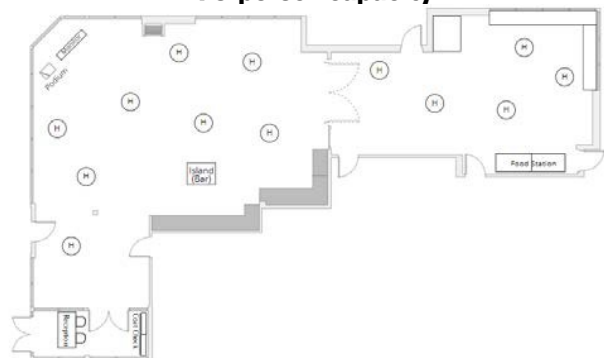

# FLEXIBLE SPACE FOR YOUR NEEDS

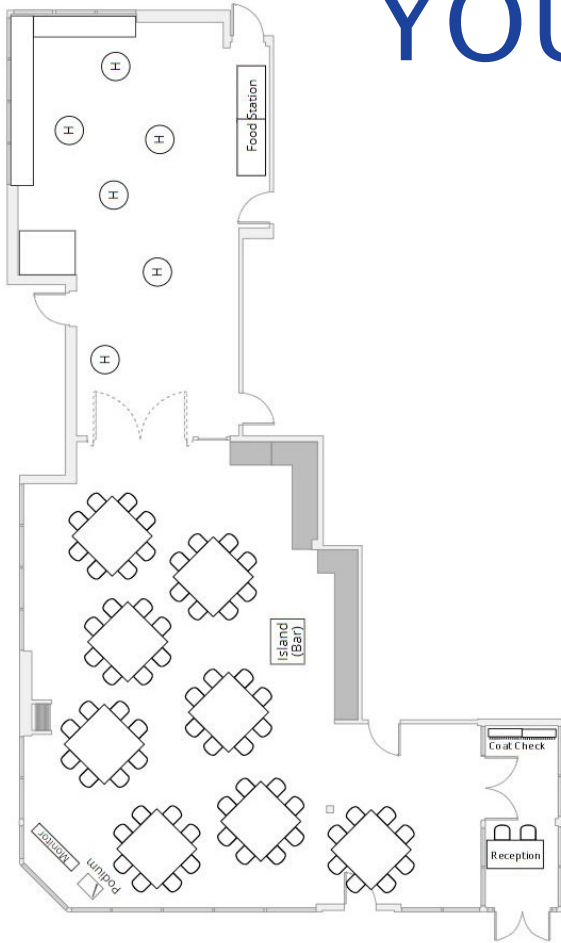

---

Our flexible space is perfect for every size group up to **75** people with the multiple configurations available. Enhance your event with mingling in the extra space provided with a cocktail reception prior to sitting down for a meal.

---

OUR FLEXIBLE SPACE ALLOWS YOU TO  
BRING YOUR VISION TO LIFE!  
CALL US TODAY TO BOOK YOUR EVENT.



**CoWorks**  
BY ELEVATE

[cwlangley@coworksbyelevate.com](mailto:cwlangley@coworksbyelevate.com)  
[www.coworksbyelevate.com](http://www.coworksbyelevate.com)  
604- 546-1540